

FOR LEASE PRIME RETAIL

Corner of
E. Burnside
& SE 28th

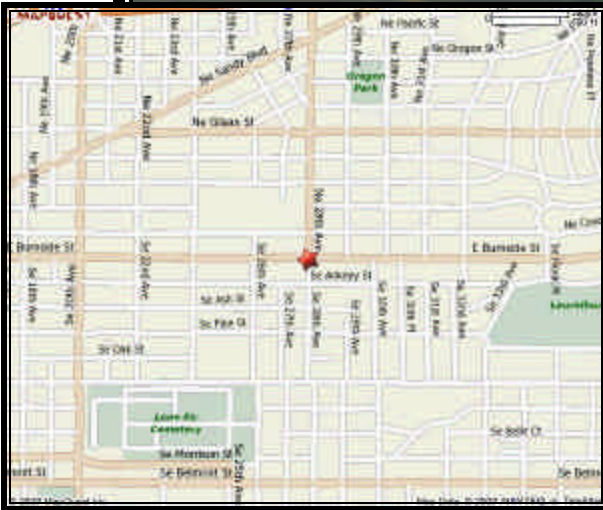

For More Information, Please Contact:

PAUL SCHRAMM, CPM, Broker
pschramm@dougebean.com

(503) 222-5100

- Space Available: 753 sq. ft. (in-line) and 6,600 sq. ft. Prime Corner Space— will divide (see reverse).
- Neighbors include: Wild Oats Marketplace, Pizzicato, Starbucks, Noble Rot, Esparzas & numerous other retailers
- **\$19.50 NNN**

• Strong Demographics:	<u>0-1 mile</u>	<u>0-3 mile</u>	<u>0-5 mile</u>
Population - 2006:	27,627	196,790	389,952
Average Income - 2006:	\$53,409	\$54,075	\$57,835



1211 SW Fifth Avenue • Portland, Oregon 97204 • (503) 222-5100 • www.dougebean.com

Information contained herein has been obtained from others and considered to be reliable. However, a prospective purchaser or lessee is expected to verify all information to his own satisfaction.

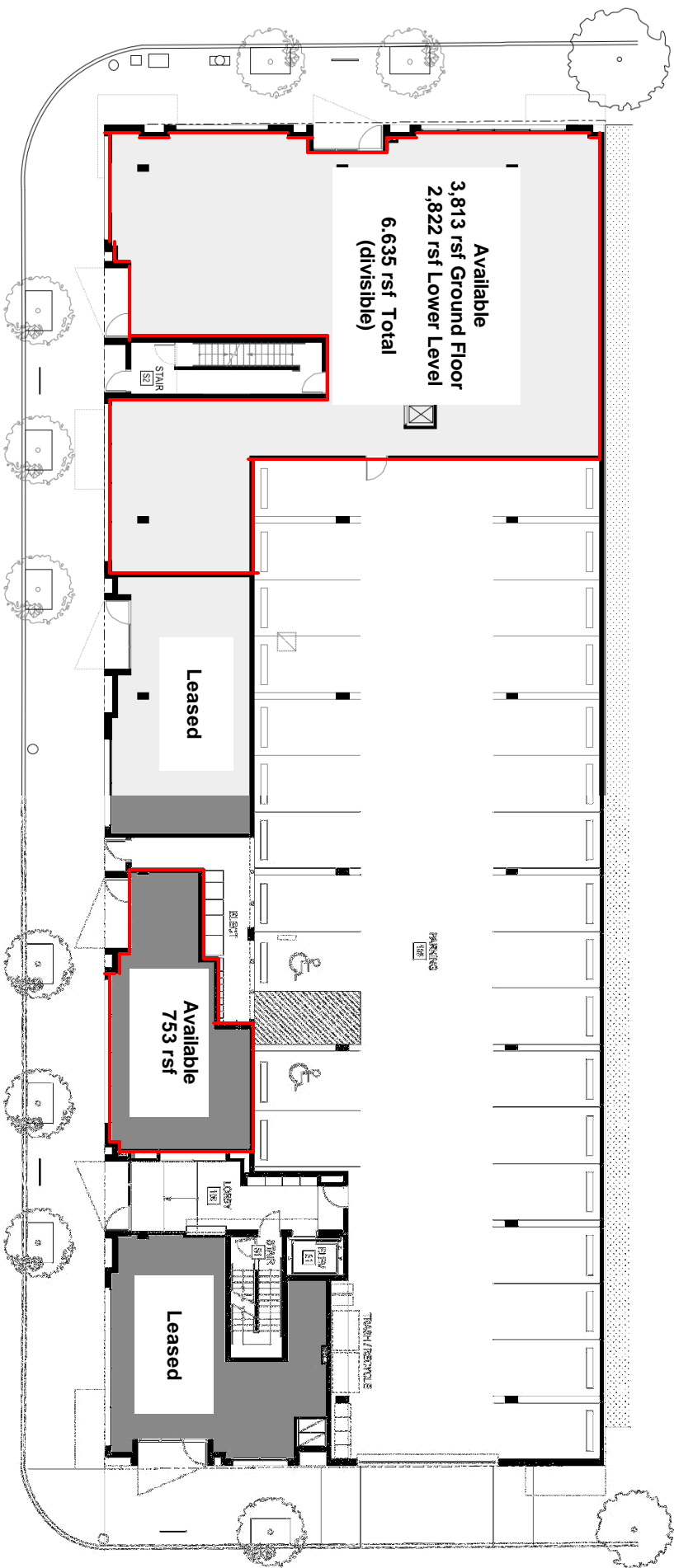

GROUND FLOOR PLAN - RETAIL

